

AUSTAL PACIFIC PATROL BOAT 40



COMMONWEALTH OF AUSTRALIA
Pacific Patrol Boat

The Pacific Patrol Boat Replacement Program (PPB-R) is part of the Commonwealth's Pacific Maritime Security Program that aims to enhance practical maritime security cooperation across the South Pacific. The PPB-R shall include 19 steel vessels for delivery to 12 Pacific Island nations from late 2018.

The all new Pacific Patrol Boat is based on Austal's proven patrol boat design platform and is 39.5 metres long with a beam of 8 metres and a loaded draft of 2.5 metres. It is capable of traveling at 20 knots and at 12 knots possesses a 3,000 nautical mile range. Each vessel can accommodate 23 people.

Austal will design, construct and deliver the 19 steel-hulled patrol boats (valued at \$280 million) to 12 Pacific Island nations. The contract includes an option for two additional vessels.

The sustainment support contract for an initial seven year period is valued at approximately \$24 million.

The vessels will be constructed at Austal's shipyard in Henderson, WA, and sustained by Austal and it's partner organisations in Cairns, Queensland; securing jobs and engaging local subcontractors across Australia.



SHIPS • SYSTEMS • SUPPORT

AUSTRALIAN DEFENCE PRIME CONTRACTOR

sales@austal.com

www.austal.com



PACIFIC PATROL BOAT DESIGN BENEFITS

The PPB-R uses a saltwater WC flush system. This reduces freshwater usage enabling reduced FW tank size and watermaker capacity and reduces through life costs.

GW/BW discharge pumps are identical, reducing sparring and providing interchangeability of parts.

Simplified mechanical system arrangement with common pumps between various systems. The sullage system allows grey water discharge overboard with STP treatment of blackwater.

Stern launch and recovery system reduces the Total Cost of Ownership of boat equipment.

The use of fuel coalesces rather than centrifuge to reduce maintenance burden.

Atmospheric crankcase breathers are utilised, eliminating through life costs associated with ingestive crankcase breathers.

The Austal PPB-R uses a common make of main engine and generators.

Similar equipment is proposed for the PPB-R when compared with current PPB installed equipment.

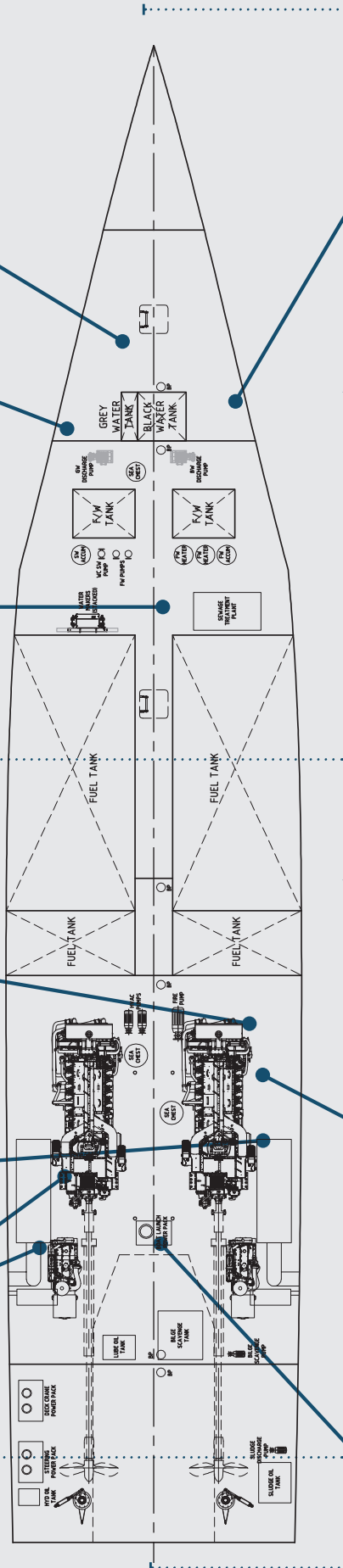

Reduction in tank numbers to simplify the fuel system arrangement.

STP that processes BW only - easier to maintain.

COTS nav and comms equipment is specified for easy operation and maintenance.

The Support System benefits from the pragmatic and sensible application of efficient and effective sustainment best practice but tailored for the Operational Model and available support infrastructure accessible to the end user.

Maintenance activities are outlined in the Sustainment Plans and are optimised for ease of maintenance and associated lower costs of ownership. This includes tailored Usage Upkeep Cycle, Usage Upkeep Plan, Annual Work Plan.

Improved fuel consumption due to electronic control of main engines.

Improved access to all voids and bilge spaces for inspection and maintenance.

Simplified monitoring and control of mechanical systems.

PACIFIC PATROL BOAT SPECIFICATIONS

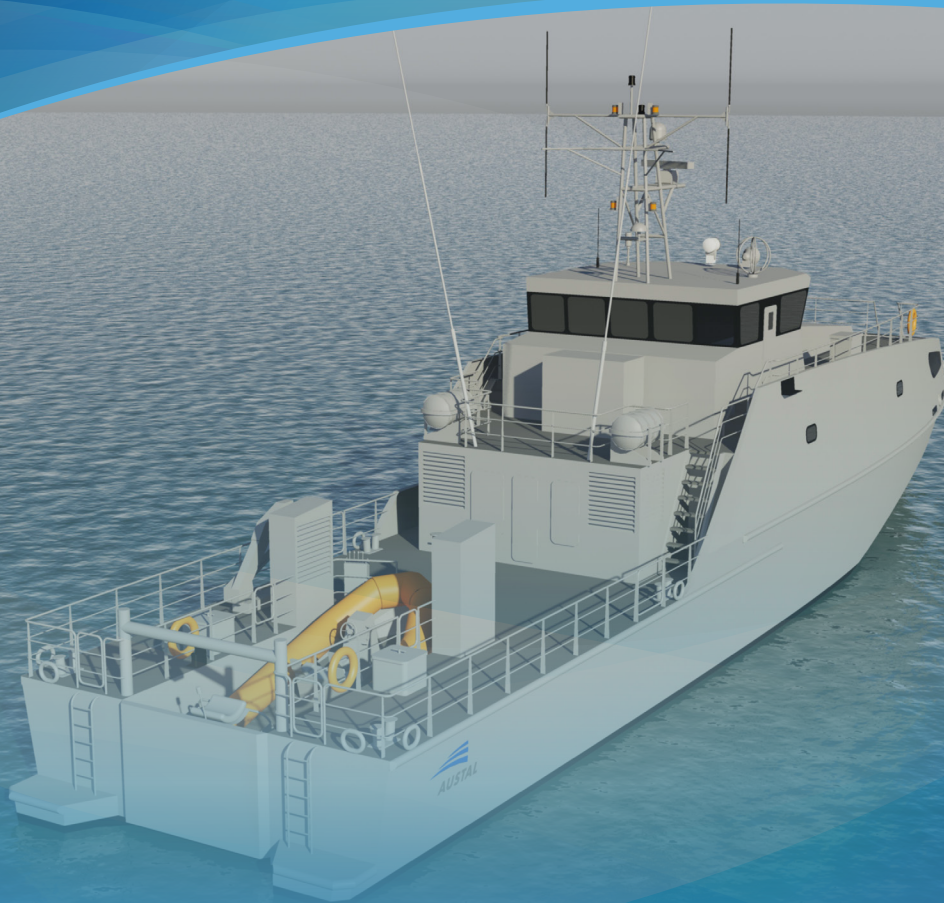

PRINCIPAL DIMENSIONS

Length overall	39.5 metres
Beam (overall)	8.0 metres
Draft, Loaded (approx.)	2.5 metres
Cargo Deck	16m ² with lashing grid serviced by crane

ACCOMMODATION

Berths	23
--------------	----

ARMAMENT

Weapons	Space and weight reservation for a 30mm main gun
.....	Port and Starboard mounts for 0.50 calibre GPMG

COMMUNICATION & SENSORS

Communication system	VHF/DSC Radios, MF/HF DSC Radios, VHF Aeroband Radio, UHF Military Radio, Inmarsat C, SatCom, HF and VHF Radio Direction Finder
Navigation	X-Band Radar, Electronic Chart System, DGPS, Gyrocompass, Autopilot, Depth Sounder

ADDITIONAL FEATURES

Ships Boat	1 x Work Ribs (WRH635FRB)
SOLAS approved fast rescue boat for 15 persons @ 100kg	
Powered by 2x90hp Yamaha outboard motors	

PROPULSION

Main engines	2 x Caterpillar 3516C
.....	2 x 2000 bkW @ 1600 rpm
Gearboxes	2 x ZF 76000 (with trolling valves)
Propellers	2 x fixed pitch

PERFORMANCE

Speed (SS4)	20 knots at 100% MCR
Range at 12 knots (SS4)	3,000 nm

CLASSIFICATION

Lloyd's Register
✱ 100A1 SSC Patrol Mono HSC G6 MCH



Pacific Patrol Boat

AUSTAL PPB 40

PROFILE

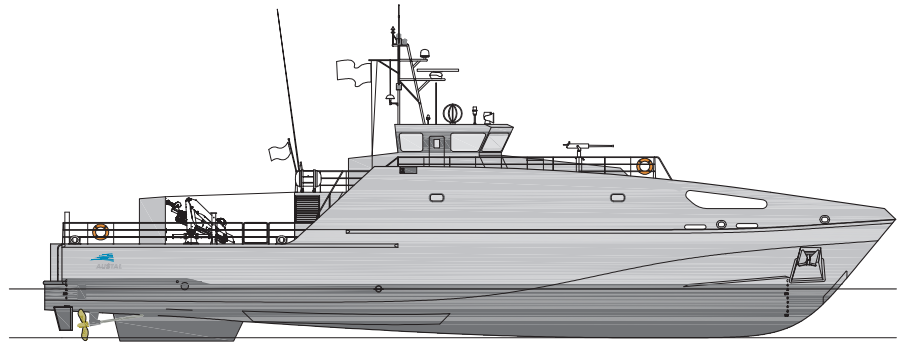

PROFILE @ CENTRELINE

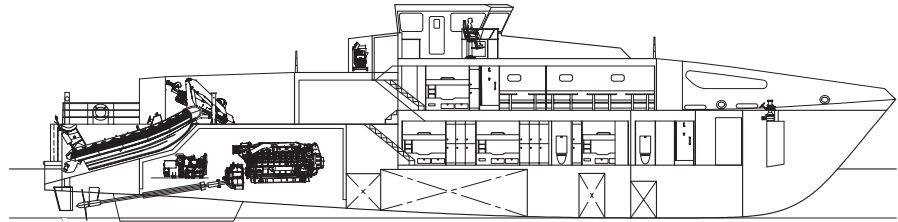

BRIDGE DECK

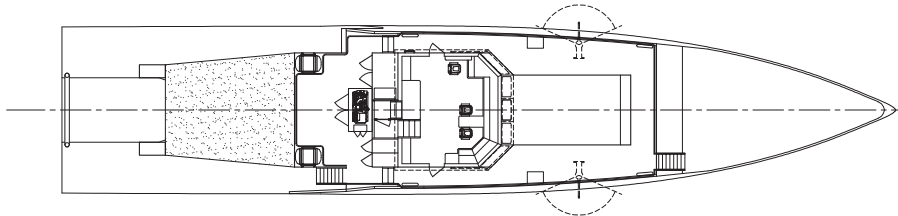

MAIN DECK

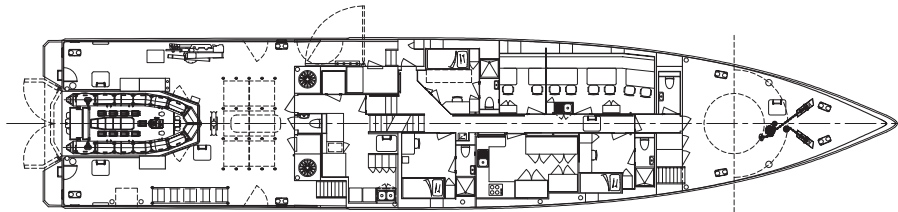

LOWER DECK

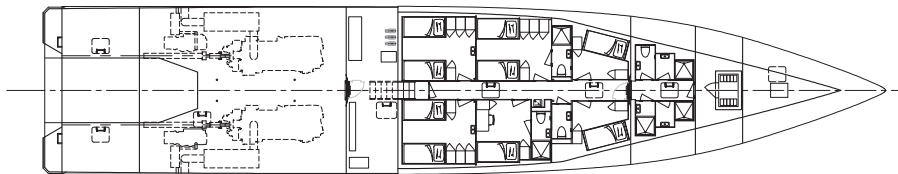

YARD NO: 321 - 339

DESTINATION: PACIFIC ISLAND NATIONS

DELIVERY: 2018 - 2023

CLIENT: COMMONWEALTH OF AUSTRALIA

100 Clarence Beach Road | Tel +61 8 9410 1111
Henderson | Fax +61 8 9410 2564
Western Australia 6166 | sales@austal.com
www.austal.com



SHIPS • SYSTEMS • SUPPORT



AUSTRALIAN DEFENCE PRIME CONTRACTOR

sales@austal.com www.austal.com

