

AUTO EXPRESS 72



"HIGH SPEED 2" & "HIGH SPEED 3"

YARD NO.: 86 & 87

DESTINATION: GREECE

DELIVERED: MAY 2000 (86) & JUNE 2000 (87)

CLIENT: MINOAN FLYING DOLPHINS

PRINCIPAL DIMENSIONS

Length overall	72.0 metres
Length waterline	63.5 metres
Beam (moulded)	17.5 metres
Depth (moulded)	5.9 metres
Hull draft (approx.)	2.5 metres
Vehicle deck clear height	2.4 metres

PAYLOAD AND CAPACITIES

Passengers	620
Vehicles	70 cars
Maximum deadweight	190 tonnes
Maximum axle loads	1.0 tonne
Crew	24
Fuel	60,000 litres

PROPULSION

Main engines	4 x MTU 16V 595 3,866kW @ 1,750rpm
Gearboxes	4 x Reintjes VJ 2230
Waterjets	4 x KaMeWa 90 S11

PERFORMANCE (with Ride Control fitted)

Speed	40.0 knots
Fuel consumption (approx.) @ 90% MCR	3.7 tonnes/hour

CLASSIFICATION

Germanischer Lloyd
✚ 100 A5, HSC-B OC3 Highspeed Passenger/ Ro.Ro Type, MC, HSC B
Hellenic Flag Authority



AUTO EXPRESS 72

Vessel type: 72m High Speed Vehicle-Passenger Catamaran

PROFILE

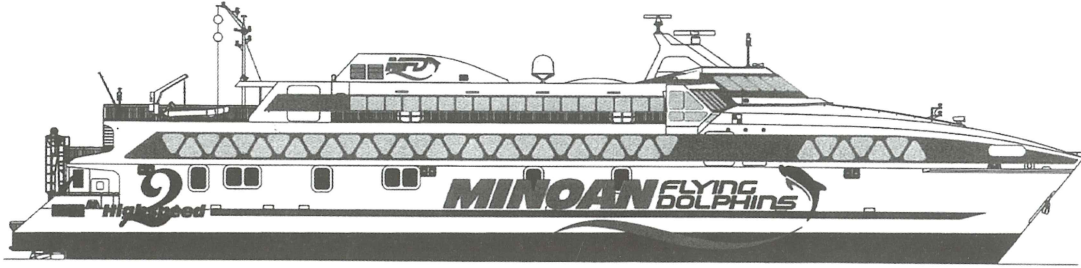

BRIDGE DECK

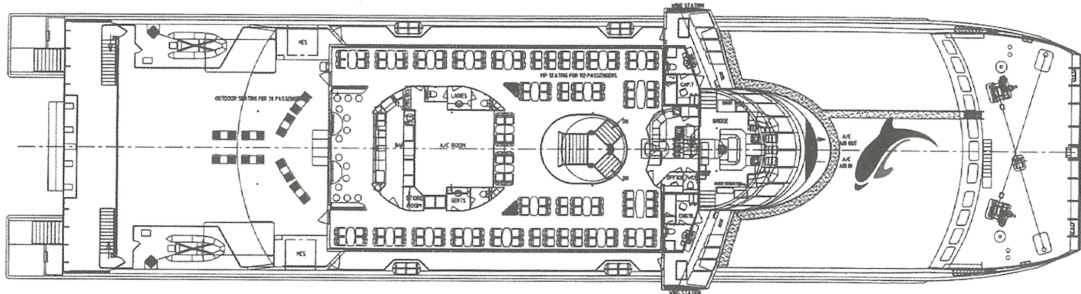

UPPER DECK

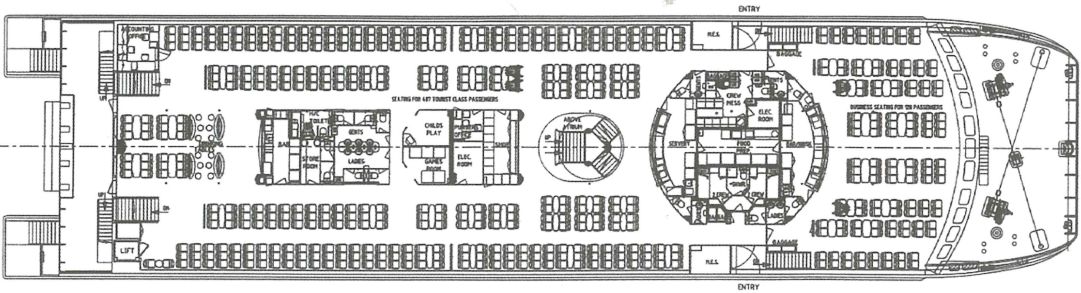

MAIN DECK

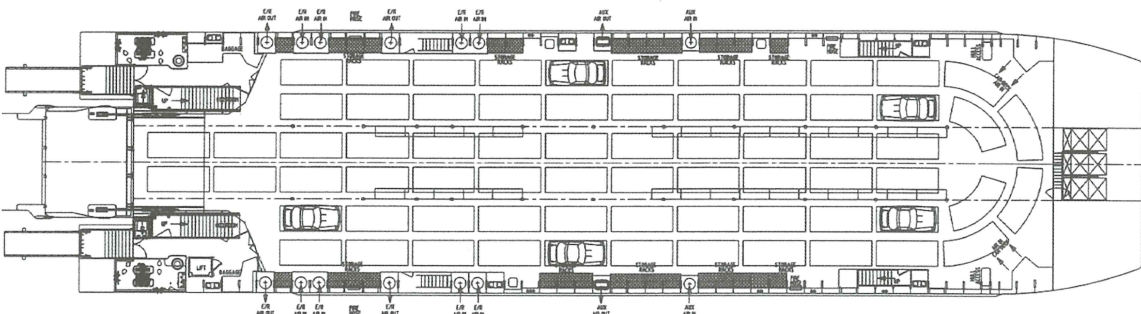

"HIGH SPEED 2" & "HIGH SPEED 3"

YARD NO: 86 & 87

DESTINATION: GREECE

DELIVERED: MAY 2000 (86) & JUNE 2000 (87)

CLIENT: MINOAN FLYING DOLPHINS

100 Clarence Beach Road
Henderson
Western Australia 6166

Tel +61 8 9410 1111
Fax +61 8 9410 2564
sales@austal.com
www.austal.com

