

# AUSTAL OFFSHORE EXPRESS 45



YASAT & GHAGHA-1

YARD NO: 348 & 349

DESTINATION: UAE

DELIVERED: AUG 2015

CLIENT: ABU DHABI NATIONAL OIL COMPANY

## PRINCIPAL DIMENSIONS

Length overall	45.6 metres
Length (waterline)	42.2 metres
Beam (moulded)	12.3 metres
Depth (moulded)	5.0 metres
Hull draft (max.)	2.2 metres

## PAYLOAD AND CAPACITIES

Passengers	160
Maximum deadweight	56.4 tonnes
Crew	12
Fuel	20,000 litres

## PROPULSION

Main engines	4 x Cummins QSK60
Gearboxes	4 x ZF7600NR2H
Waterjets	4 x Rolls Royce 56 A3

## PERFORMANCE

Speed (90% MCR)	35.0 knots
-----------------	------------

## CLASSIFICATION

Lloyds Register  
 ✕100AI SSC, Passenger (A), Catamaran, HSC, G3  
 ✕LMC, PAC (3), COMF - C (3), CCS (DNV)  
 UAE Flag



# AUSTAL OFFSHORE EXPRESS 45

Vessel type: 45m High Speed Crew Transfer

YASAT & GHAGHA-1

YARD NO: 348 & 349

DESTINATION: UAE

DELIVERED: AUG 2015

CLIENT: ABU DHABI NATIONAL OIL COMPANY

PROFILE

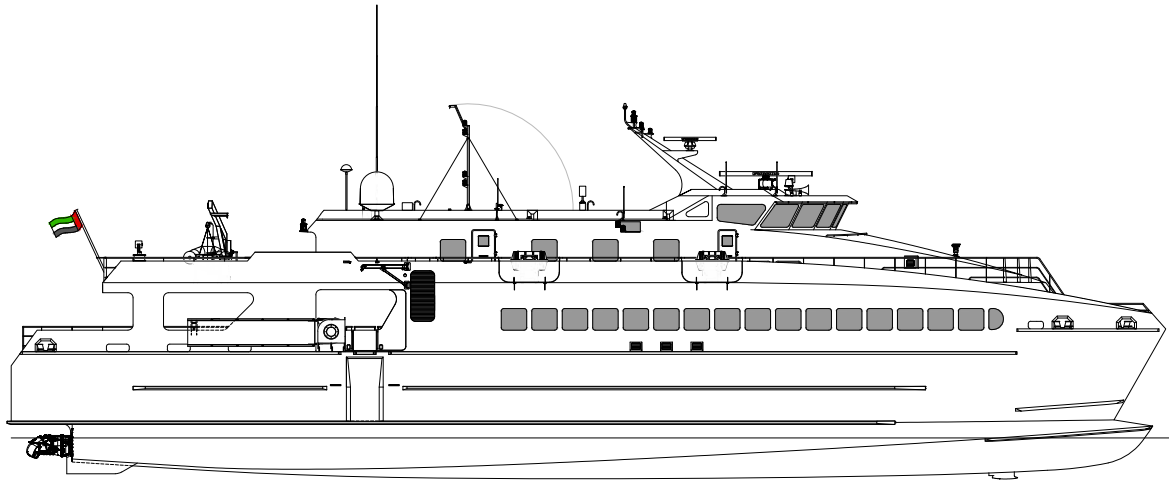

UPPER DECK

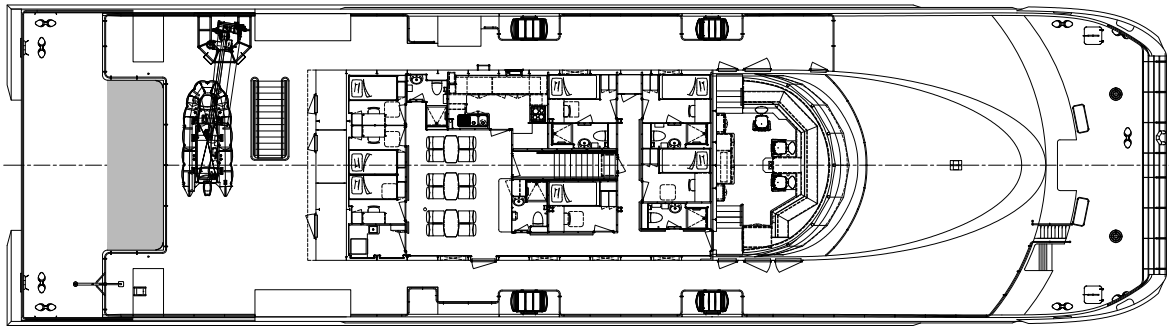

MAIN DECK

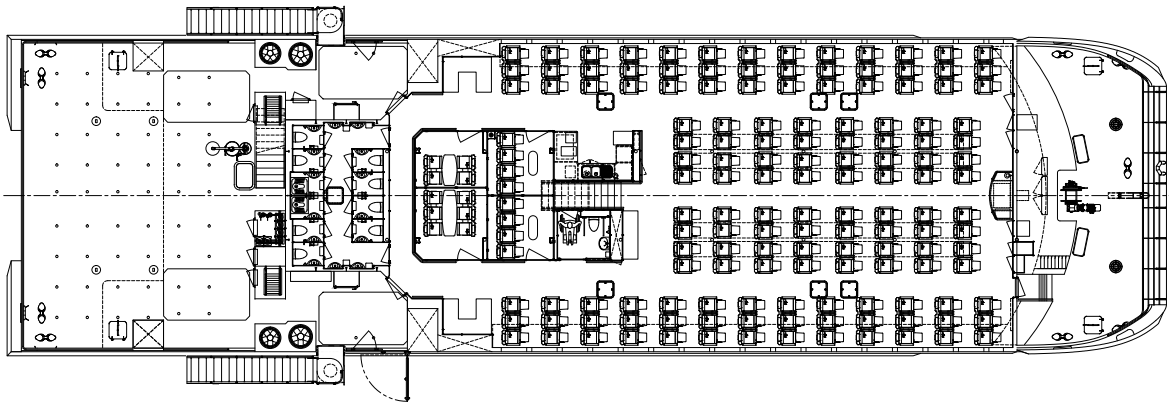

HULLS

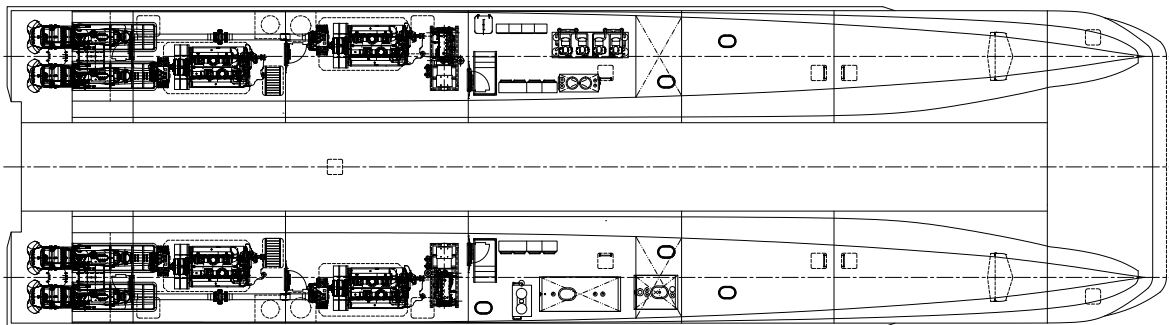

100 Clarence Beach Road  
Henderson  
Western Australia 6166

Tel +61 8 9410 1111  
Fax +61 8 9410 2564  
sales@austal.com  
www.austal.com

