

# AUSTAL 48



“UNIVERSAL MK 2011” AND “UNIVERSAL MK 2012”

YARD NO: 401 & 402

DESTINATION: HONG KONG

DELIVERED: 2008

CLIENT: SHUN TAK - TURBOJET

## PRINCIPAL DIMENSIONS

Length overall	47.5 metres
Length (waterline)	44.0 metres
Beam (moulded)	11.8 metres
Hull depth (moulded)	3.8 metres
Hull draft (maximum)	1.4 metres

## PAYLOAD AND CAPACITIES

Passengers	418
Crew	8
Maximum deadweight	55.7 tonnes
Fuel	20,000 litres

## PROPULSION

Main engines	4 x MTU 16V 4000 M70 4 x 2,320 kW @ 2,000 rpm
Gearboxes	4 x Reintjes VLI 930
Waterjets	4 x Kamewa 63 SII

## PERFORMANCE

Service speed (95% MCR)	44.1 knots
Fuel consumption (approx.) @ 100% MCR	1.87 tonnes/hour

## COMFORT ENHANCEMENT

Active T-Foil and Interceptor Ride Control System (optional fit)

## CLASSIFICATION

Det Norske Veritas  
 ✕ 1A1 HSLC Passenger R2 EO  
 Hong Kong (SAR)

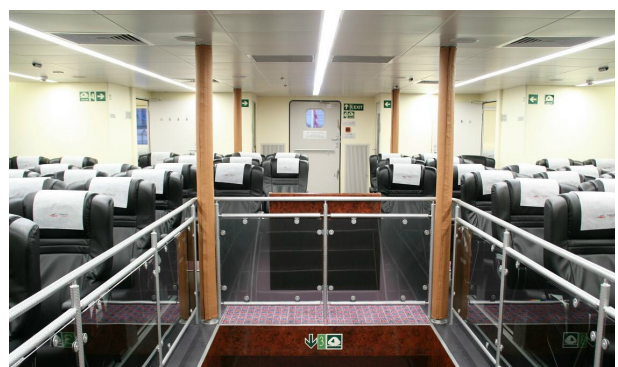

# AUSTAL 48

Vessel type: 48m High Speed Passenger Catamaran

YARD NO: 401 & 402

DESTINATION: HONG KONG

DELIVERED: 2008

CLIENT: SHUN TAK - TURBOJET

PROFILE

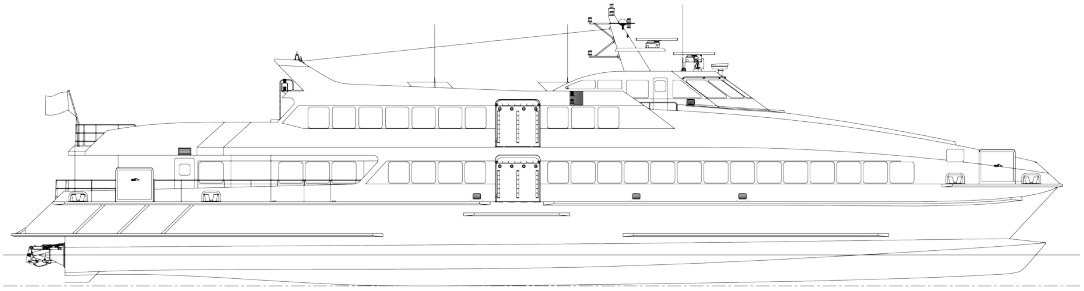

UPPER DECK

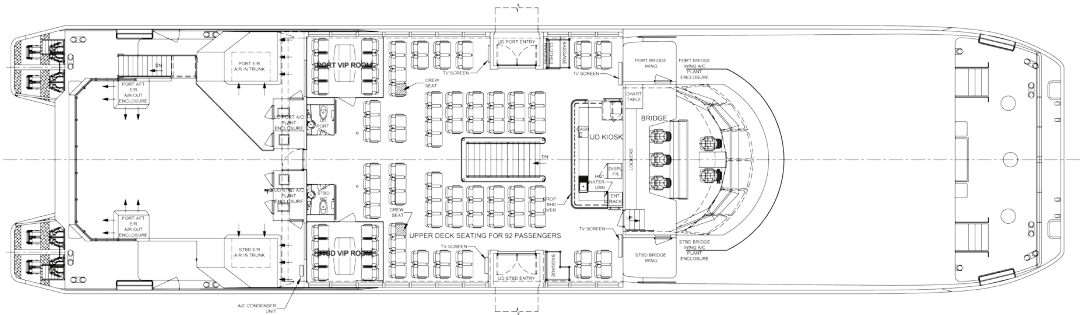

MAIN DECK



HULLS

