

AUTO EXPRESS 49



AREMITI 6

YARD NO.: 421

DESTINATION: FRENCH POLYNESIA

DELIVERED: AUGUST 2019

CLIENT: SNC AREMITI

PRINCIPAL DIMENSIONS

Length overall	49.9 metres
Length (waterline)	46.90 metres
Beam (moulded)	14.20 metres
Hull depth (moulded)	5.00 metres
Hull draft	1.90 metres
Vehicle deck clear height	2.60 metres

PAYLOAD AND CAPACITIES

Passengers	550
Main deck seating	226
Upper deck seating	324
External seating	70
Crew	8
Cars (maximum)	6
Motorcycles (maximum)	30
Maximum deadweight	80 tonnes

PROPULSION

Main engines	4 x MTU 16V4000M63L (IMO Tier II) 4 x 2,240 kW @ 1800rpm
Gearboxes	ZF 7650 NR2H
Waterjets	4 x Hamilton Jets HT 810

PERFORMANCE

Speed	37.2 knots @ 100% MCR
Range	270 Nm

CLASSIFICATION

Society	DNV-GL
Class Notation	✱ 1A HSLC R2 Ferry A, E0
Flag State	France



AUTO EXPRESS 49

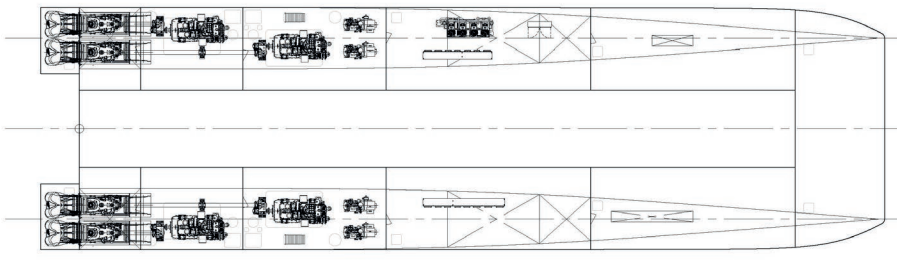
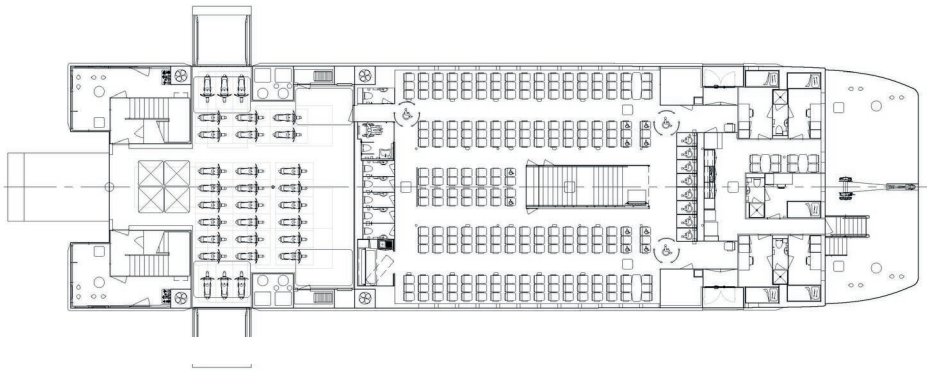
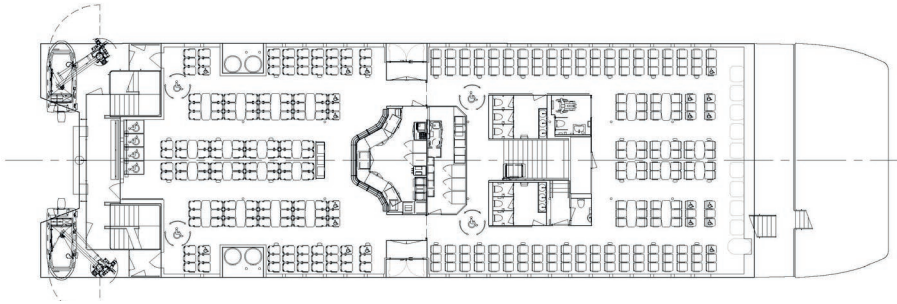
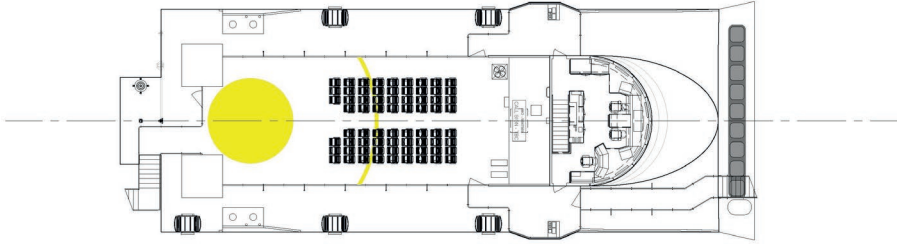
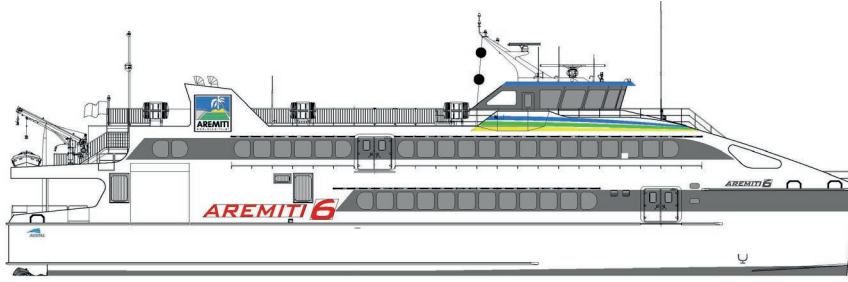

AREMITI 6

YARD NO: 421

DESTINATION: FRENCH POLYNESIA

DELIVERED: AUGUST 2019

CLIENT: SNC AREMITI



100 Clarence Beach Road
Henderson
Western Australia 6166

Tel +61 8 9410 1111
Fax +61 8 9410 2564
sales@austal.com
austal.com